

ITEM NO.	PART NUMBER	DESCRIPTION	MATERIAL	DRAWING #	QTY.
1	FI .375 X 1.25 L 2	LENGTH: 2"	FI 3/8x1-1/4"	STOCK	1
2	FP-HYDRA HOOK	HYDRA HOOK FOR HYDRA BED	1-1/4" HRS	95-2104	1
3	OP-D-RING 58-3	D-RING 5/8		STOCK	1
4	RT 4x2x.25 L 12.5	LENGTH 12-1/2	RT 4 x 2 x 1/4	STOCK	1

REVISIONS			
REV.	DESCRIPTION	DATE	APPROVED
A	INITIAL RELEASE	3/20/2013	

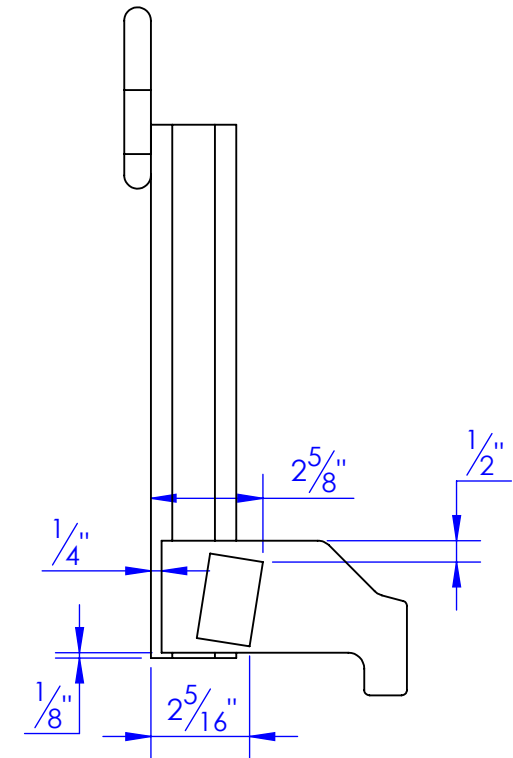
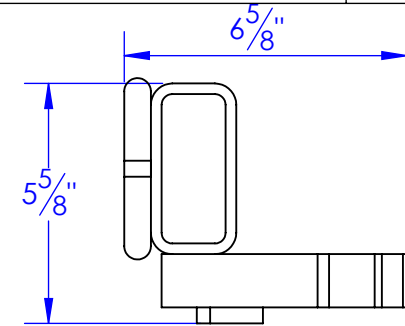
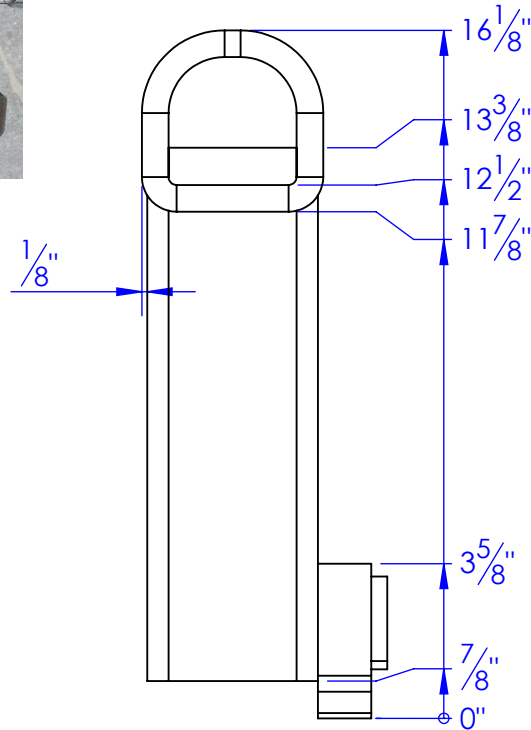
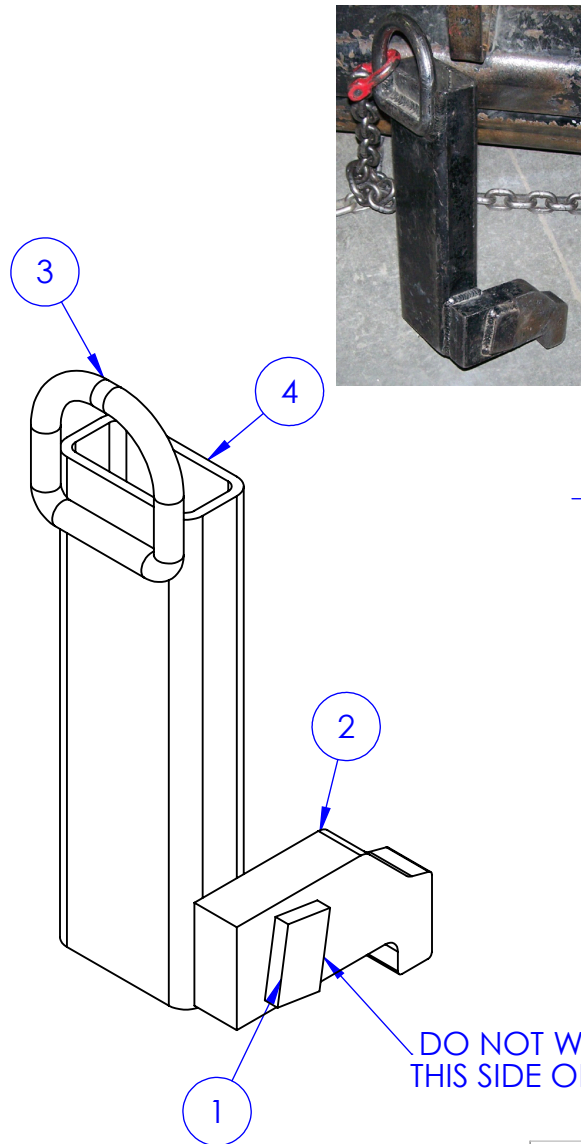

DO NOT WELD ON
THIS SIDE OF BLOCK

PROPRIETARY AND CONFIDENTIAL
THE INFORMATION CONTAINED IN THIS
DRAWING IS THE SOLE PROPERTY OF TRIPLE
C INC. ANY REPRODUCTION IN PART OR
AS A WHOLE WITHOUT THE WRITTEN
PERMISSION OF TRIPLE C INC. IS PROHIBITED.

DIMENSIONS ARE IN INCHES
TOLERANCES:
FRACTIONAL $\pm 1/16$
ANGULAR: MACH ± 1 BEND \pm
TWO PLACE DECIMAL ± 0.10
THREE PLACE DECIMAL ± 0.005

MATERIAL ---
DO NOT SCALE DRAWING

NAME	DATE
DRAWN HEATH	3/20/2013
PART #	
ASM #	OP-HYDRA HOOK

COMMENTS:
HYDRA HOOK
FOR HYDRA
BEDS ASSEMBLE

P.O. BOX 248,
SABETHA, KS 66534

TRIPLE C
INC.

SIZE A	DWG. NO. 95-1107	REV. A
SCALE: 1:4.5	WEIGHT: 14.69	SHEET 1 OF 1